

TEN offer an extensive range of Hand Tools & Truck kit tooling.

- ▶ Ratchet Spanners and Podgers
- ▶ Hand and Battery style Ratchet cutters
- ▶ Cable preparation and stripping tools
- ▶ Deep and Tubular Impact sockets
- ▶ Temporary Earth Stake and Earth Rod Driver
- ▶ Conductor Scratch/Cleaning Brushes
- ▶ Conductor diameter Gauges
- ▶ 1000v Insulated tools



HAND TOOLS - TABLE OF CONTENTS

Ratchet Wrenches and Podgers.....	G4	Chuck, Quick Change 7/16" Female to 1/2" Female	G10
4 Way Ratchet Wrench - NGK	G4	Special Drive Sockets.....	G10
2 Way IPC Ratchet Wrench.....	G4	"J" Hook Driver - Slot Socket PLUS.....	G10
2 Way Ratchet Podgers	G4	D-Bolt Socket - 450mm Long	G10
Single Ratchet Podger	G4	1/2" Drive Socket Sets	G10
Ratchet Cutters - ACSR - Steel - Copper - Aluminium.....	G5	Deep Impact Socket Set - 26 Piece Kit	G10
ACSR - Steel - Guy Cable Cutters	G5	Extra Deep Tube Socket Set - 7 Piece Kit	G11
Copper - Aluminium Cable Cutters.....	G5	METRINCH Socket Set - 15 Piece Kit	G11
Ratcheting Cable Cutter - Reliable.....	G5	Banding System - Stainless Steel	G12
Cutters.....	G6	BAND-IT® Banding System	G12
Battery Operated Ratchet Cutters	G6	Ball-Lokt™ Banding System	G12
Battery & Charger - Makita.....	G6	Conductor Scratch/Cleaning Brushes.....	G13
Bolt Cutters - Crescent.....	G6	Scratch Brush - "Dog-bone and FlatRound" - Madi	G13
Cable Cutter - AL/CU - Klein.....	G7	Scratch Brush and Safety Knife - Madi	G13
Cable Cutter - AL/CU - Klein.....	G7	Conductor Scratch Brushes.....	G13
Parrot Beak Cable Cutter AL/CU	G7	Stick Scratch Brushes - Hastings.....	G13
Universal Cutting Plier	G7	Cable Preparation Tools.....	G14
1000V Universal Cutting Plier.....	G7	Drill Driven Cable Stripper - Utility Tool	G14
1000V Side Cutters.....	G7	2 and 4 Way Cable Stripper - LV ABC - Utility Tool	G14
1000V Long Nose Pliers.....	G7	ABC Strippers	G14
Various Line-worker Tools	G8	Outer Sheath Stripper - Ratcheting - Ripley	G15
Adjustable Wrenches - Shifter	G8	Outer Sheath Ripper Stripper	G15
Line Tap Spanners.....	G8	Adjustable Outer Sheath Stripper Tool	G15
Crimping Tools for tubular lugs.....	G8	Outer Sheath Stripping Tool	G15
Crimping Tools for tubular lugs.....	G8	Sheath Stripper	G15
Hand Ratchet Crimper - 14mm OD	G8	Cable Sheath & Insulation Stripper.....	G15
1m 4-Fold Ruler	G8	Adjustable Sheath and Insulation Stripper	G16
Wedge Separation Tool ABC 4 x 95mm ²	G9	Adjustable Sheath and Insulation Stripper	G16
Core Separation Wedge ABC 4 x 95mm ²	G9	Outer Sheath & Insulation Strippers.....	G16
Insulated Cable Test Point	G9	Plier Style Sheath Strippers.....	G17
LV/ABC Tool & Test Kit.....	G9	Semi-Con, Sheath and Insulation Stripper	G18
Cleaning Wipes - GrimeAway Multi Purpose.....	G9	Semi-Con Scorer - Peelable	G18
		Semi-Con Scorer - Peelable	G18



HAND TOOLS - TABLE OF CONTENTS

Chamfer Tool - Insulation	G19	Knives	G25
Chamfer Tool - Cable Stripper	G19	Hacksaw	G25
Safety Knife - Madi	G19	Screwdrivers	G26
Safety Knife and Scratch Brush - Madi	G19	Flat Blade	G26
Safety Knife	G19	Phillips Head	G26
Cable Skinning Knife - Klein	G19	Shifters and Spanners	G26
ACSR Strippers	G20	Shifters (Standard Insulated & Fully Insulated)	G26
Conductor Diameter Gauges	G20	Offset Ring	G27
Conductor Gauge - TEN	G20	Straight Ring	G27
AL, CU & ACSR - Common Conductor Sizes	G20	Single Open Ended	G27
Temporary Earth Stake - TEN	G21	Wrenches	G28
Earth Rod Driver - iTOOLco	G21	Reversible Ratchet Wrenches - ½" & ¾" Drive	G28
1000V INSULATED HAND TOOLS	G23	Torque Wrenches - ½" Drive - 8-60Nm	G28
Multi-grip and Pliers	G23	Torque Wrenches - ¾" Drive - 4-20Nm	G28
Multi-grip Pliers	G23	Torque Wrenches - ¾" Drive - 8-60Nm	G28
Long Nose Pliers - Fully Insulated	G23	T-Handle Wrench - ½" Drive	G28
Combination Pliers	G23	¾" Drive 6 and 12 Point Sockets	G29
Cutters	G23	Socket Extensions	G29
Diagonal Cutters	G23	125mm & 250mm Long	G29
Cable Cutters	G23	Sockets ¾" and ½" Drive	G29
Ratchet Cutters	G24	12 Point Socket - ½" Drive	G29
ACSR, AL and CU	G24	6 Point Socket - ½" Drive	G29
Parrot Beak Cutters - Large	G24	12 Point Long Socket - ½" Drive	G29
AL, CU and Steel	G24	Hex Head Socket - M200 (¾") & M250 (½")	G30
Bolt Cutters	G24	Offset Socket - 17 & 19mm	G30
1000V Insulated Battery Powered Cutters	G24	Fixed Socket - T handle Wrench	G30
20mm Cutter	G24	Radio and T-Handle Sockets	G30
25mm Cutter	G24	Allen Keys	G31
32mm Cutter	G24	T-Handle	G31
50mm Cutter	G24	Curved (+Set) Short Connector & Screwdriver Handle	G31
Knives & Hacksaw	G25	Fuse Extraction Tool	G31



**Require tools and equipment for a new truck?
TEN can customise a kit to suit Line-workers, apprentices and crew requirements**

**FOUR sizes in ONE**

Ratchet Wrenches and Podgers

4 Way Ratchet Wrench - NGK

Part No. BY-3

- Four sizes in one
- Plastic ergonomic non-slip handle with grips

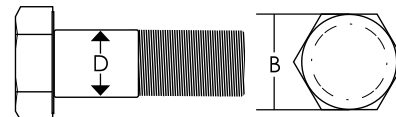

D	10mm	12mm	16mm	20mm
B	17mm	19mm	24mm	30mm

2 Way IPC Ratchet Wrench

Part No. RS1317-Series

Reversible ratchet spanner.

The 6 point hex is ideal for 1.5 - 240mm² IPC's

- Ideal for IPC's
- Straight Plastic Handle
- Available with long or short handle
- Forward and reverse ratchet mechanism

Part No.	Handle	Size OAL (mm)	Hex
RS1317-6SH	Short Handle	13 & 17 210	6pt
RS1317-6LH	Long Handle	13 & 17 250	6pt
RS1317	No Handle	13 & 17	6pt



Suits IPC's

Spanner Ratchet 13 & 17mm Reversible 6 Point Hex Suits IPC's 1.5 - 240mm² with short handle or long handle

Short or Long Handle

2 Way Ratchet Podgers

Part No. RRP-Series

The R-series Podgers from TEN are precisely machined, heat treated and zinc plated. Each podger ratchet consists of two drive socket heads of different sizes within a heavy duty 32 tooth ratchet mechanism. Dual head ratchets allow speed and efficiency on the job.

- Reversible with continuous taper
- 12pt Hex - refer table below
- 13 - 24mm available with plastic handle
- Forward and reverse ratchet mechanism
- 2 sizes of double hexagonal sockets per tool

12pt HEX

Part No. (no handle)	Part No. (with handle)	Size (mm)	Hex
RRP1317	RRP1317-H	13 & 17	12pt
RRP1719	RRP1719-H	17 & 19	12pt
RRP1824	RRP1824-H	18 & 24	12pt
	RHP1824	18 & 24 (Folding Handle)	12pt
RRP1921	RRP1921-H	19 & 21	12pt
RRP1924	RRP1924-H	19 & 24	12pt
RRP2124	RRP2124-H	21 & 24	12pt
RRP2427	RRP2427-H	24 & 27	12pt
RRP2430	RRP2430-H	24 & 30	12pt
RRP3032	RRP3032-H	30 & 32	12pt
RRP3036	RRP3036-H	30 & 36	12pt
RRP3236	RRP3236-H	32 & 36	12pt
RRP38BS16	RRP38B16-H	3/8" BS/16mm	12pt

Single Ratchet Podger

Part No. RRP36/H

12pt HEX

Part No. (no handle)	Part No. (with handle)	Size (mm)	Hex	Length (mm)
RRP36	RRP36-H	36	12pt	450



Lanyard can be threaded through anchor hole for added safety



Handle Version



Breaking blades?
Solution - RC-32ACSR
AL/CU/ACSR/ST
CUTTERS

JennyTools



9009



RC-32ACSR



63607

**KLEIN
TOOLS**

Ratchet Cutters - ACSR - Steel - Copper - Aluminium

Part No. Various

- Suitable for Cutting ACSR - Steel - Copper - Aluminium (See table below)
- From 15mm to 52mm (See table below for cutting capacity of each tool)
- Patented two-step ratchet mechanism requires fewer strokes per cut
- Quick-release lever opens blades easily in every cutting position
- Handle locks in closed position for storage and transportation
- Full ratcheting cycle and release in all cutting positions
- Ergonomic handles design to maximise cutting leverage

ACSR - Steel - Guy Cable Cutters

Klauke®
A Textron Company



K1062



K683T

Copper - Aluminium Cable Cutters

Part No.	Cable Dimensions Max Diameter (mm)			Length OAL (mm)	Tool Wt (kg)
	Cu	Al	ACSR / St / Guy		
9009	15	18	ACSR - 15 / Steel - 5	267	0.5
63607	18	22	ACSR - 17 / Steel - 10	260	0.7
RC-32ACSR	32	32	ACSR - 20 / Steel - 5	254	0.7
K1062	52	52	-	280	0.7
K683T	32	32	-	260	0.7

Ratcheting Cable Cutter - Reliable

Part No. REL-R-HC

- Jaw keeper prevents the jaws from spreading while under heavy load
- Shear-cut blades
- Ratchet and chain increase cutting pressure as handles open and close
- Moderate pressure opens & closes handles.
- Mechanical advantage over manual cutters

Part No. REL-R-SC

- Cut Copper & Aluminum cable up to 50mm, including rubber or lead covered cable
- Heavy duty jaw and ratchet design provides mechanical advantage over manual cutters
- Does not cut steel



Part No.	Cable Dimensions Max Diameter (mm)			Length OAL (mm)	Tool Wt (kg)
	Cu	Al	ACSR		
REL-R-HC	30	30	30	736	4.5
REL-R-SC	50	50	-	736	4.4



Cutters

Battery Operated Ratchet Cutters

Part No. RCB-Series

Battery Operated Ratchet Cutters, designed for cutting a variety of OH Conductors & UG cables, including CU, AL & ACSR. Supplied with or without batteries and charger. Versatile Makita platform

Features

- Ergonomically designed
- One handed operation
- Makita 18V 3.0Ah Li-ion Battery & 230VAC Rapid Charger

Plastic Moulded case included



Specifications

Part No.	Head Style	Cuts	Jaw opening (mm)	Capacity (mm)			Dimensions (mm) (L x W x H)	Wt (kg) Inc. Battery
				CU	AL	ACSR		
RCB-52ACSR	Ratchet	ACSR	52	-	-	22.5	190 x 110 x 320	3.9
RCB-65N	Ratchet	AL / CU	65	41.5	41.5		175 x 110 x 320	3.5
RCB-50Y	Scissor Ratchet	AL / CU	50	32	32	-	160 x 110 x 370	4.4



RCB-52-ACSR

Cuts
ACSR



RCB-65N

Cuts
AL/CU



RCB-50Y

Cuts
AL/CU

Scissor Head
"IDEAL"
for confined spaces

Order Information

Part No.	Includes	Kit Part No.	Kit Includes
RCB-52-ACSR-0	Cutter skin & case	RCB-52-ACSR-K	Cutter skin, 2 x 3.0Ah batteries, charger and case
RCB-65N-0		RCB-65N-K	
RCB-50Y-0		RCB-50Y-K	



DC18RC

Battery & Charger - Makita

Part No. Various

- Makita 230VAC Rapid Charger
- Makita 18V 3.0Ah Li-ion Battery

BL1830B



Bolt Cutters - Crescent

Part No. Various

- High-leverage jaws with shear-cut blades
- PowerPivot™ Technology



Part No.	Length (mm)	Tool Wt (kg)
0090MCP	460	2.2
0190MCP	600	2.5

See Insulated Tool section for 1000V Insulated Bolt Cutter





Cable Cutter - AL/CU - Klein

Part No. 63035

- Maximum cutting capacity 22mm Aluminium & Copper
- 425mm Length

Cable Cutter - AL/CU - Klein

Part No. 63050

- Maximum cutting capacity 12mm Aluminium & Copper
- High-leverage design for exceptional cutting capability
- Hot-riveted joint ensures smooth action and no handle wobble
- 241mm Length

Parrot Beak Cable Cutter AL/CU

Part No. 0890CSJ

- Special alloy hardened blades
- Comfort grips
- High-leverage jaws with shear-cut blades

Universal Cutting Plier

Part No. 3800CTV

- Premium quality forged alloy steel for toughness and durability
- Precise jaw gap for wire work with cross hatch jaws for positive grip
- Serrated pipe grip
- Extended and hardened cutting jaw for use with flat multi-core cabling
- Built in crimper for use on 1.5mm² to 6mm² solderless connectors
- Length 200mm

1000V Universal Cutting Plier

Part No. 3800CHV

- 1000V Universal Plier with crimper
- Length 200mm

1000V Side Cutters

Part No. 5428HV

- 1000V Diagonal cutter
- Length 200mm
- Electronically Induction Hardened Cutting Edges

1000V Long Nose Pliers

Part No. 6547HV

- Precise Jaw for wire work
- Cross hatch jaws for positive grip



Various Line-worker Tools

Adjustable Wrenches - Shifter

Part No. AC2-Series

- Wide capacity jaw allows each tool to work with more fastener sizes
- Tension spring stabilises jaw and knurl adjusts easily
- Wider handle on sizes provides more comfort & less stress on the hand
- Alloy steel and heat treated and plated finish resists rust and corrosion

Part No.	AC26VS	AC28VS	AC210VS	AC212VS	AC215VS	AC218VS
Size (mm)	150	200	250	300	380	460
Size (Inches)	6	8	10	12	15	18

Line Tap Spanners

Part No. HLTS Series

Part No.	Description	Weight (kg)
HLTS-4	Spanner for brass Line Taps & IPC's (4 way)	0.20
HLTS-2	Spanner for brass Line Taps & IPC's (2 way)	0.15
HLTBS-6	Line Tap Spanner Base (6 way)	0.20

Crimping Tools for tubular lugs

Part No. HRC-0506C

- Ratchet hand Crimpers
- Capacity 0.5mm² to 6mm² - RED/YELLOW/BLUE
- 230mm Long

Crimping Tools for tubular lugs

Part No. Various

- With revolving dies
- Simple and safe: Exact cross-section assignment thanks to permanent marking on the dies

Part No.	Description	Length (mm)	Weight (kg)
HX-50N	Hex Hand Crimping tool 6 - 50 mm ²	390	1.3
HX-120N	Hex Hand Crimping tool 6 - 120 mm ²	627	3.6

Hand Ratchet Crimper - 14mm OD

Part No. MP-10-SIMPI

- 9mm "W" captive die, for pre-insulated service sleeves

1m 4-Fold Ruler

Part No. LFSSI

- Sturdy folding rules available with Square Edge.
- Clear metric & imperial markings

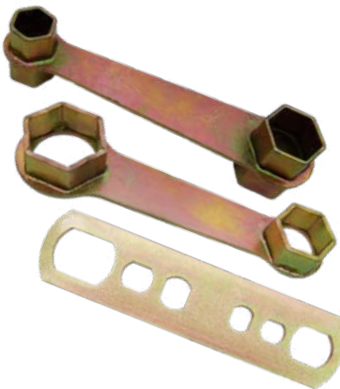

Wedge Separation Tool ABC 4 x 95mm²

Part No. ST-31

- Core separation wedge
- Suitable for LVABC up to and including 4 x 95mm²
- Supplied with interconnecting rope

Core Separation Wedge ABC 4 x 95mm²

Part No. PMR87

- Core separation wedge
- Suitable for LVABC up to and including 4 x 95mm²
- Hex nut style head suits the 2 way IPC ratchet wrench for turning
- Sold individually

Insulated Cable Test Point

Part No. PP1514

- Re-usable insulated cable test point
- Suitable for cable ranges up to 150mm²
- Sold individually

LV/ABC Tool & Test Kit

Part No. TENK013

Part No.	Description	Quantity
PP1514	Insulated Cable test point	4
RRP1317-6LH	Ratchet Podger Wrench 13 & 17mm	1
ST-31	Core Separation Tool - Corded	1pr
PMR87	Wedge Separators	2
TENM514	ABC Kit Storage Bag	1



RRP1317-6LH



PP1514



PMR87



ST-31



HTC-D72

**IDEAL for
cleaning dirt
& grime from
your hand
tools**

Cleaning Wipes - GrimeAway Multi Purpose

Part No. HTC-Series

Tough on Dirt, but Field Friendly

Polywater® Grime-Away™ quickly and effectively removes hydraulic fluids, silicone greases, and adhesives from transformers, vehicles, heavy machinery, tools, and hands for a clean and safe working environment. Its unique water-based formulation is especially safe on skin, unlike most other tool and hand cleaners. Grime-Away is available in a multiple-use, 72-count canister or individual wipes that store easily in tool pouches or lineman bags.

Part No.	Description	Pack
HTC-D72	Dispenser with 72 Pre-moistened wipes *	72 Wipes

* Not suitable for Rubber Goods



Chuck, Quick Change 7/16" Female to 1/2" Female

Part No. 2403

- Super Heavy Duty 7/16" (1/2" Square Drive) Quick-Change Chuck.
- Three ball bearing system to firmly secure you auger bits and adapters.
- Designed to be used with high torque 1/2" square drive impact wrenches.



Special Drive Sockets

"J" Hook Driver - Slot Socket PLUS

Part No. SS-2



Multi-Use Eye Bolt Type Clamp and Wing Nut Applications



Features

- High Visibility ID Band
- Impact Rated
- Improved Fit on Large J Hooks (Off-Set & Centre)
- Earthing Clamps
- Hot Line Clamps
- Cross-Arm Hardware
- Stringing Block
- Temporary Arm Insulators

Suits
Off-Set &
Centred
J-Hooks

1/2"
Drive

D-Bolt Socket - 450mm Long

Part No. TENA517

- Use with cordless drills

Part No.	Description	Length (mm)	Weight (kg)
TENA517	Socket for Pillar Box D-Bolts	450	0.50

1/2" Drive Socket Sets

Deep Impact Socket Set - 26 Piece Kit

Part No. 658272601

26 Piece 1/2" Drive, 12-Point Deep Impact Socket Set

Includes: 10, 11, 12, 13, 14, 15, 16, 17, 18, 19, 20, 21, 22, 23, 24, 25, 26, 27, 28, 29, 30, 32, 33, 34, 35 & 36mm stored in a Blow Mould Case.



Extra Deep Tube Socket Set - 7 Piece Kit

Part No. 605290701

7 Piece 1/2" Drive, 6-Point "TUBE" Deep Impact Socket Set

Includes: 19mm, 21, 24mm, 27mm, 30mm, 32mm and 36mm @ 250mm Long Blow Mould Case



Part No.	Size (mm)	D2 (mm)	D1 (mm)	L2 (mm)	L (mm)	Hole Clearance (d)
60529018	18	28	28	13	250	14
60529019	19*	28	28	13	250	14
60529021	21*	28	31	13	250	16
60529024	24*	28	35	15	250	18
60529027	27*	32	38.5	17	250	22
60529030	30*	32	42	17	250	22
60529032	32*	34	44	19	250	24
60529036	36*	36	49	19	250	26

* Sizes included in set

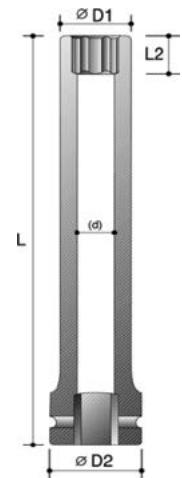

METRINCH



The Metrinch 6 wall drive system means that one tool set is all you need to service your equipment, whether it's made in Germany, the USA or Australia.

METRINCH Socket Set - 15 Piece Kit

Part No. MET-2450

Get More Use Out of Fewer Tools

Metrinch means fewer tools and easier selection as each tool can be used for both metric and inch, plus damaged nuts and bolts. This eliminates switching back and forth from imperial to metric.

Unique Patented Design

The 4-point grip design enables Metrinch sockets and spanners to fit multiple sizes and damaged or rounded nuts.

More Torque, Less Wear

By exerting pressure through the walls, Metrinch grips more securely than conventional sockets.

Non Slip Hold

No more cut hands, banged up knuckles and elbows due to wrench slippage.

Quality

All Metrinch tools are forged from high grade chrome vanadium steel for lifetime use.



Unique 6 Wall Drive System
This 15 Piece socket set equals a 42 piece conventional set

Individual sizes available

Fit	1/2" Drive	
Metric (mm)	30	32
SAE/AF (Inch)	1 3/16	1 1/4
Length (mm)	86	

*All sizes available individually

Included sizes in Socket Set*

Fit	1/2" Drive							
Metric (mm)	11	12	13	14	15	16	17	18
SAE/AF (Inch)	7/16	15/32	1/2	9/16	19/32	5/8	11/16	23/32
Length (mm)	80							

Fit	1/2" Drive							
Metric (mm)	19	20	21	22	23	24	25	
SAE/AF (Inch)	3/4	25/32	13/16	7/8	29/32	15/16	1	
Length (mm)	80				86			



BAND-IT® 201 Stainless Steel band



Ear-Lokt Buckle



Band-it Tool 001



Ball-Lokt Stainless Steel Tie



Ball-Lokt Tie Tool

Banding System - Stainless Steel

BAND-IT® Banding System

Part No. Various

BAND-IT® 201 Stainless Steel Bands

The BAND-IT® type 201 Stainless steel non-magnetic band is the preferred option in all general use banding applications, offering high tensile strength and good resistance to oxidation and weathering. Available in a variety of widths and thicknesses.

In addition, EASYSCALE – imprinted measurements on the band, help determine band length and eliminate costly waste. Packaged in a standard box or a durable plastic tote for easy dispensing.

Part No.	Width (mm)	Thickness (mm)	Weight per roll (kg)
BAND-IT® S-Steel band (30.5m Roll)			
C202	6.35	0.51	0.9
C203	9.53	0.64	1.5
C204	12.70	0.76	2.4
C205	15.88	0.76	3.0
C206	19.05	0.76	3.6
BAND-IT® S-Steel Buckles (100 per pack)			
C252	6.35		0.1
C253	9.53		0.3
C254	12.70		0.8
C255	15.88		0.9
C256	19.05		1.5
Tool for BAND-IT® Band & Buckles			
001	6 - 20		2.0

Ball-Lokt™ Banding System

For applications ranging from identification tagging to bundling cables, Ball-Lokt™ Ties in 316 stainless steel, provide a longer life than nylon ties, especially in extreme climates.

Easy dispensing.

Self-locking design installation by hand or with the KS 652 tool, to assure uniform tension and clean tail cut-off for safe handling.

Ideal for conductor wire grip application

Part No.	Width (mm)	Length (mm)	Weight per pack (kg)
Ball-Lokt™ S-Steel Ties (100 per pack)			
KT6U046-200	4.6	200	0.25
KT6U046-350	4.6	350	0.4
KT6U046-500	4.6	500	0.5
KT6U078-200 *	7.8	200	0.5
KT6U078-350	7.8	350	0.75
KT6U078-500	7.8	500	0.9
Tool for Ball-Lokt™ Ties			
KS652-TOOL *	Tensioner & Cutter		0.6

* Banding Tool & Band-Lokt Ties for Wire Grip fitting

Self-Locking Application

1. As the stainless steel band is inserted into the buckle, the internal locking ball rolls freely
2. During tensioning, the band wedges onto the buckle locking tightly between the buckle and the band

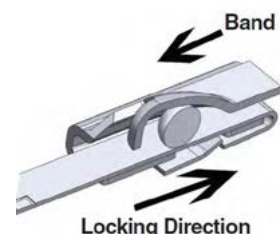



MADI
INNOVATIVE LINEMAN TOOLS



DBWB-1



FRWB-1



BB-2S



Replaceable
Brushes
(10-179)



Conductor Scratch/Cleaning Brushes

Scratch Brush - "Dog-bone and FlatRound" - Madi

- Designed to encourage linemen to brush with a more convenient and ergonomic design making it more convenient than ever before
- Replaceable brush inserts make a cost effective solution
- Suitable for use up to 45mm conductor
- Made from Non-conductive materials
- Minimise open neutrals and bad connections by brushing conductors properly

Part No. DBWB-1

- Dog-bone design, colour and marking for copper one end and aluminium the other

Part No. FRWB-1

- Designed for both flat and round connection such as palms
- Replaceable brush inserts suitable for both flat and round ends

Part No.	Description	Wt (kg)
DBWB-1	Dog-bone Scratch Brush (includes one set of inserts)	0.25
FRWB-1	Flat Round Scratch Brush (includes one set of inserts)	0.25
LWB-1	Replacement Wire Brush for DBWB-1 / FRWB-1	0.1

Scratch Brush and Safety Knife - Madi

Part No. BB-2S

- Integrated wire brush for cleaning conductors to make better connections
- Replaceable brush inserts make a cost effective solution
- Suitable for use up to 25mm conductor
- Blunt Tipped fold-away blade for added safety
- Stainless steel blade for maximum durability and sharpness

Part No.	Description	Wt (kg)
BB-2S	Fold-away Safety Knife and Round Scratch Brush	0.23
WB-1	Replacement Wire Brush for BB-2S	0.1

Conductor Scratch Brushes

Part No. SB-3 & SB-4

- Used for preparing the surface of conductor prior to applying a connector/splice
- Tough stainless steel bristles resist rust
- Copper or aluminium available - use only on specified conductor to prevent cross contamination

Part No.	Colour	Conductor Type	Wt (kg)
SB-3	White	Aluminium	0.1
SB-4	Black	Copper	0.1

Stick Scratch Brushes - Hastings

Part No. Various

Part No.	10-178	10-180	10-179
Description	Complete "V" Brush unit with Handle for Gloved Hands, Shotgun Ring, Replaceable Brushes (10-179)	Complete "V" Brush unit with Universal Head Attachment, Replaceable Brushes	Pack of 10 Replacement Brushes
Material	Thermoplastic Handle & S/S Bristles	Al Alloy Body & Stainless Steel Bristles	Stainless Steel Bristles



SCAN or
CLICK
to see the
stripper in
action



Cable Preparation Tools

Drill Driven Cable Stripper - Utility Tool

Part No. WS68-3-8

Power Driven Cable End Stripper

The Utility Tool LV Cable Strippers are a fast, safe and economical stripping tool with interchangeable square cut bushings for a wide range of common Australian LV cables. Easily setup with your chosen bushing, the tool can be quickly attached to your cordless driver for effortless cable stripping.

Benefits

- Increases safety by eliminating use of traditional knives, reducing the risk of cuts or lacerations
- Easily attaches to power drill for safe & efficient cable stripping
- Adjustable strip lengths from 15.9mm to 63.6mm
- Increases splice & union reliability with accurate strips every time
- Use with bushings specifically designed to suit 16-150mm² Australian conductor
- For Low Voltage Applications
- Evenly Strips Insulation
- The optional WS68 Snaps patent-pending Quick Connect Adapter makes changing bushings faster & more efficient - even with gloves only

Unique Australian Bushing Part No's



Part No.	Square Cut Bushings
	LV ABC
RB-100	10mm ² Al XLPE OH
RB-101	16mm ² Al XLPE OH
RB-200	25mm ² Al XLPE OH
RB-201	35mm ² Al XLPE OH
RB-300	50mm ² Al XLPE OH
RB-301	70mm ² Al XLPE OH
RB-400	95mm ² Al XLPE OH
RB-401	120mm ² Al XLPE OH
RB-500	150mm ² Al XLPE OH
Part No.	Underground
RB-102	16mm ² Cu XLPE/PVC LV UG (Olex)
RB-202	35mm ² Cu XLPE/PVC LV UG (Olex)
RB-302	50mm ² Cu XLPE/PVC LV UG (Olex)
CB6667	Bushing spare blade

Contact TEN for information on the full range of available bushings

2 and 4 Way Cable Stripper - LV ABC - Utility Tool

The Utility Tool LV Cable Strippers are a fast, safe and economical stripping tool with interchangeable square cut bushings for a wide range of common Australian LV cables. Available in a 2 bushing body or 4 bushing body, these are easily setup with your go to bushings.

- Safer than ripping tools/strippers with a guarded cutting blade
- Fast and simple to use
- Precise stripping with no conductor damage
- Suitable for XLPE, PVC and EPR insulations
- Commonly used for ABC and SDI cables
- Made in the USA

**See above table for
available Bushings**

Part No.	Description
36101H	Stripper, cable, body only, 2x2, includes allen keys, Ripley
36001H	Stripper, cable, body only, 4x4, includes allen keys, Ripley
40110	Adapter, snap on to suit 2x2 and 4x4 strippers for quick bushing change, Ripley

ABC Strippers

Part No. ABC-STRIPPER

- Removes tough insulation from low voltage aerial cables

Part No.	For	Suits Cable (mm ²)	Spare Blade #	Wt (kg)
ABC-STRIPPER-95	ABC	95	ABC-STRIPPER-B	0.1
ABC-STRIPPER-150	ABC	150	ABC-STRIPPER-B	0.1

Outer Sheath Stripper - Ratcheting - Ripley

Part No. US14-7000

Ratcheting outer sheath cable splitter removes the outer sheath from HV and LV cables. The US14 easily performs ring cuts and slit mid-spans on ducts and heavy-duty cables.

- Equipped with safe, recessed blade to prevent potential injury & blade damage
- Compatible with high fiber count fiber optic cables
- Micro-adjustable blade depth adjusts up to (5 mm) to avoid underlying cable damage



Part No.	Description	Min Cable (mm)	Spare Blade #	Wt (kg)
US14-7000	Ratcheting Slitter	25	US14-7500	0.18

Outer Sheath Ripper Stripper

Part No. HRIPS

- For safe removal of outer sheaths
- Reversible blade has blunt mushroom head which stops damage to inner core

Part No.	Suits Cable	Spare Blade #	Wt (kg)
HRIPS	LV & HV	HRIPS-B	0.2

Adjustable Outer Sheath Stripper Tool

Part No. R3840

- Adjustable cutting-depth by thumb wheel
- Circular and longitudinal cutting
- Replacement blade in the handle

Part No.	Strip Range (mm)
R3840	8 to 28

Outer Sheath Stripping Tool

Part No. AM2

- Auto-Tensioning - Adjustable cutting-depth by thumb wheel
- Circular and longitudinal cutting
- Replacement blade in the handle

Part No.	Strip Range (mm)
AM2	25 to 36

Sheath Stripper

Part No. IBST5024

- Used for removal of core insulation
- Removes insulation up to 5.5mm
- Cable range from 12 - 38mm (50 - 400mm²)
- Long life blade - Spare Blade Part No. IBST5024B

Cable Sheath & Insulation Stripper

Part No. 1542-2CL-1

- Tool with Wedge Blade installed, spare straight blade
- 45mm max cable diameter
- Precise blade depth adjustment to 12mm
- Removes PE, XLPE, EPR and other insulation types from HV power cable
- No bushings required
- Spare Blade Part No. 1562



UtilityTool®

A RIPLEY® BRAND



SCAN or CLICK for more information

Perfect for Mid-Span & End Stripping on CCT, Hendrix, Spacer Wire & Tree Wire Cables

Adjustable Sheath and Insulation Stripper

Part No. US01-7000

The industry's most versatile, reliable and accurate adjustable tool for mid-span and end stripping on HV and LV utility cables.

Features

- Easily strip mid-span double insulations in one go for direct connection via PG or Wedge Style connector, or strip outer sheath only for insulated piercing connectors (IPC's)
- Eliminates the need for traditional stripping knives, reducing the risk of cuts or lacerations
- Heavy duty tool easily removes jacket & various types of insulation materials
- Patent-pending, self-aligning design maintains optimum blade position to produce precise cuts for reliable splices & connections
- Well-balanced tool has low friction parts & ergonomic handles to reduce effort & potential strain from repetitive stripping functions
- Spare blades also available: (US01-7500)

Compatibility

Cable Type		HV and LV Utility Cables
Cable Size (mm)		12.7 to 63.5
Compatible Materials	Jacket	URD, PE, PVC, Copper Tape Shield, LC Shield, Flat Strap
	Insulation	XLPE, PE, EPR
Cable Access		Mid Span & End Strip
Blade Adjustability	Angle	Yes
	Depth (mm)	Yes (1.5 to 10.6)
Removable Handles		Yes

Adjustable Sheath and Insulation Stripper

Part No. US07-7000

US07 Adjustable Cable Stripper that quickly and easily end strips or midspan strips cable insulation with no conductor damage on 7.6mm to 35mm OD cables. The tool utilizes a size adjustment clamping system to swiftly adjust and lock onto the insulation.

Features

- Equipped with safe, recessed blade to prevent potential injury & blade damage
- Easily adjusts with detent actuated knob & fine adjustment knob to match
- Insulation thickness for fast stripping without conductor damage
- Durable bronze bushings provides longevity
- Spare blades also available: (US07-7500)



Compatibility

Cable Type	HV and LV Utility Cables
Cable Size (mm)	7.6 to 35
Materials Jacket	URD, PE, PVC
Cable Access	Mid Span & End Strip
Blade Depth (mm)	Adjustable (1.15 to 3.2)
Removable Handles	Yes

Outer Sheath & Insulation Strippers

Part No. POLY

- Large knobs for opening/closing jaws and offsetting tool
- Locknut on opening/closing knob for maintaining position
- Blade direction lever and knurled cutting depth knob
- Directional markings on body
- Stainless steel and aluminium alloy construction



Part No.	Capacity (mm)	Cutting Depth (mm)	Suits Jackets	Retract Stop (mm)	Spare Blade
POLY	7 - 33	12	All (XLPE/EPR/PVC/PE)	20-110	LAME-POLY-L



SCAN or CLICK for more information

Quickly adjusts and clamps on to cable diameters from 7.6mm to 35mm



SCAN or CLICK for more information

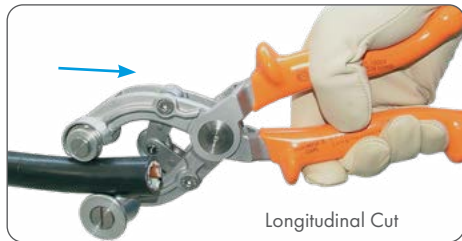
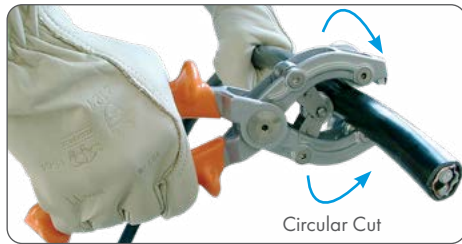

SCAN/CLICK for a copy of the PAD/PBT ordering Guide

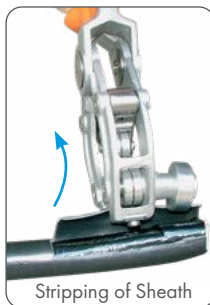

Plier Style Sheath Strippers

Plier type Sheath strippers, for circular & longitudinal cutting with end ripping claw blades

- 1000V Insulated and Non-insulated models available
- Plier type strippers, circular/longitudinal cut with end ripping blade
- Replaceable cutting blades (available in kits)
 - 3 or 4 x Circular cutting blades, 1 x Lengthwise cutting blade and 2 x Claw blades
- Ideal for stripping Sector or deformed cable
- Lead Sheath stripper available



Replaceable Cutting Wheels & Claw Blades
SCAN or CLICK QR-Code for ordering guide



Part No.	Insulated	Circular Cut Depth (mm)	Lengthwise Cut Depth (mm)	Capacity (mm)	Wt (kg)
PAD12-16A	No	1.2	1.6	10-45 OD	0.75
PAD16-20A	No	1.6	2	10-45 OD	0.75
PAD30-30A	No	3	3	10-45 OD	0.77
PAD32-34A	No	3.2	3.4	10-45 OD	0.77
PAD40-40A	No	4	4	10-45 OD	0.77
PBT IS 12 16 A	1000V	1.2	1.6	10-45OD	0.6
PBT30-30A	1000V	3	3	10-45 OD	1.3
PBT40-40A	1000V	4	4	10-45 OD	1.3
PBT20-20B	1000V	2	2	20-45 OD	1.3

Other sizes and blade combinations available

Specifications



PBT Model
Insulated 1000V EN60-900



PAD Model
Non-insulated model, black sheathed



PBT IS Model
Fully Insulated 1000V EN60-900

Part No.	LxWxD (mm)	Range (mm OD)	Wt (g)	Part No.	LxWxD (mm)	Range (mm OD)	Wt (g)	Part No.	LxWxD (mm)	Range (mm OD)	Wt (g)
PBT (A)	283 x 78 x 80	10-45	720	PAD (A)	283 x 78 x 90	10-45	720	PBT IS (A)	270 x 81 x 95	10-45	560
PBT (B)	283 x 78 x 80	20-54	720	PAD (B)	283 x 78 x 90	20-54	720	PBT IS (B)	270 x 81 x 95	20-54	560



PAD32-34A
Ideal for stripping CCT



Ideal for stripping Sector or deformed cable



Replaceable Adjustable
Wheels SCAN or CLICK QR-
Code for ordering guide

Replaceable 0-4mm Adjustable
Longitudinal Blade



DERANCOURT

Semi-Con, Sheath and Insulation Stripper

Part No. POLY Series

Strips Semi-Con, Outer Sheath and Insulation with one tool

- 3 Strippers in one
- 25mm² to 630mm² Capacity
- Suitable for a wide range of material e.g. (XLPE/EPR)
- 12mm Cutting Depth



POLY-SCP



SCAN or CLICK for
more information



POLY-SCNP

Part No.	Semi-Con Type	Cable Dia (mm)	Cutting Depth (mm)	Replacement Blade	
				Sheath & Ins	Semi-Con
POLY-SCNP	Non-Peelable	7 to 33	0 to 12	LAME-POLY-L	LAME-OUT-SCNP
POLY-SCP	Peelable			LAME-POLY-L	LAME-OUT-SCP-CH



Semi-Con Scorer - Peelable

Part No. SCS

Compact & user-friendly tool scores semi-con on HV cables without damaging the insulation

- Eliminates the need for traditional stripping knives, reducing the risk of cuts or lacerations
- Performs longitudinal & spiral cuts on cable diameters ranging from 8 to 51 mm
- Precise & easily adjustable blade depths from 0 to 4 mm in increments of 0.05 mm
- Adjustable blade pitch accommodates various cable diameters



Part No.	Cable Dia (mm)	Blade Depth (mm)	Replacement Blade
SCS	8 to 51	0 to 4	43645

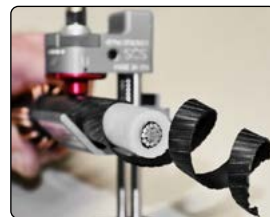

Semi-Con Scorer - Peelable

Part No. BC-UTT23521 / 2

- Scores Semi Conductive Screen on HV cables
- Screen simply peels away
- Choose blade depth

Part No.	Depth of scoring (mm)
BC-UTT23521	0.4
BC-UTT23522	0.6





Chamfer Tool - Insulation

Part No. US-10 Series

Insulation Chamfering Tool utilizes a size adjustment clamping system to quickly and easily adjust and lock onto the insulation.

- Performs a angle bevels with a factory-set chamfer depth of 1.9 mm
- Adjustable from 0 mm to 3.81 mm
- Equipped with safe, recessed blade to prevent potential injury & blade damage

SCAN or CLICK for more information



Part No.	Tool Type/ Application	Cable Insulation Capacity (mm)	Replacement Blade
US10-7000	30° Bevel Edger	14 - 60	US10-7500
US10-7001	45° Bevel Edger	14 - 60	US10-7501

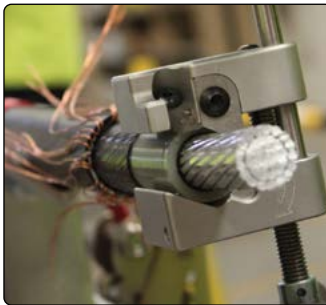

Chamfer Tool - Cable Stripper

Part No. CHANFREIN-DT

- Chamfers a 30° angle bevelled edge on the insulation
- Hard Aluminium Clamps
- Stainless Steel fittings



Part No.	Tool Type/ Application	Cable Capacity (mm)	Replacement Blade
CHANFREIN-DT	30° Bevel Edger	9 - 33	LAME-CHANFREIN-DT

Safety Knife - Madi

Part No. FBSK-2S

- Safety Blade with Protective sheath – No Cut Blade Except for Recessed Area
- Ergonomic Design with Over Mold for Secure Grip
- Finger Guard for Maximum Safety
- High Grade Stainless Steel Blade for Maximum Durability for the Toughest Insulation
- Blade & Snap Ring are Molded for Superior Strength & Separated by Non-conductive Material

Part No.	Description	Wt (kg)
FBSK-2S	Fixed Blade Blunt tipped safety knife	0.2

Safety Knife and Scratch Brush - Madi

Part No. BB-2S

- Integrated wire brush for cleaning conductors to make better connections
- Replaceable brush inserts make a cost effective solution
- Suitable for use up to 25mm conductor
- Blunt Tipped fold-away blade for added safety
- Stainless steel blade for maximum durability and sharpness

Part No.	Description	Replacement Brush	Wt (kg)
BB-2S	Fold-away Safety Knife & Round Scratch Brush	WB-1	0.23

Safety Knife

Part No. KNIFE082

- Twin Blade with Blade cover
- Strong Durable high impact body
- Unique design prevents injury

Suitable for Pole Top
Rescue Kits

Cable Skinning Knife - Klein

Part No. 1570-3

- 75mm Hook Blade
- Notched Blade for scraping



FBSK-2S



BB-2S





ACSR Strippers

Part No. PSC-1

The Trimmer quickly and accurately removes the aluminium stranding from around the steel core of ACSR conductors in preparation for crimping the steel inner strand.

Features

- Made of an aluminium alloy
- Lightweight and durable
- Operates like a Tube Cutter
- Carry Case stores 11 bushings
- Standard Bushing sizes available (Sold separately)
- Bushings can be made to suit a wide range of ACSR conductors



Bushing Holder



Bushing

Part No.	Kit Contains	Bushings to suit	Replacement Cutting Wheel #
PSC-1	Tool, bushing holder, (1) extra cutting wheel, and a plastic case that holds up to 11 bushings.	Lime Cherry Mango Grape Lemon Lychee Orange Olive Pawpaw	TE54270
TE****	Bushing for use with PSC-1, *conductor to be specified		-

*Other size bushings available on request

PSC-2 Trimmer and Bushings available for larger size ACSR conductors
Please contact TEN for further information

Conductor Diameter Gauges

Conductor Gauge - TEN

Part No. CG-430-AU

HDPE slide gauge quickly & easily identify conductor OD

**Reduce Incorrect
Conductor
Identification**

- Designed for Australian AL, CU & ACSR conductors
- For conductors 4.0 - 30mm Ø
- Measure Live Conductors
- Fits universal sunrise fitting

Part No.	Dimensions (mm)	Weight (kg)
CG-430-AU	104 (W) x 287 (L) x 10 (D)	0.26

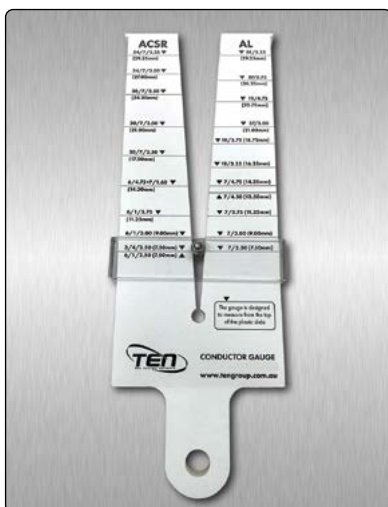

AL, CU & ACSR - Common Conductor Sizes

Part No. CG-EQL Series

Quickly & easily identify common overhead electrical distribution conductor or wire sizes in AL, CU & ACSR. Markings include conductor name, stranding and overall diameter.

- Hole in base for use with a shotgun stick and hanging storage
- Imperial and metric sizes included
- Precision machined from lightweight aluminium alloy



Part No.	Conductor Range	Dimensions (mm)	Wt (g)
CG-EQL-ALCU	Copper 7/.064 - 4.87mm to 19/2.75 - 13.8mm	257 (W) x 91 (L) x 14 (D)	750
	Aluminium Locust - 7/.093 - 7.08mm to Taurus - 19/4.75 - 23.80mm		
CG-EQL-ACSR	ACSR Quince - 5.25mm to Wolf - 18.13mm	209 (W) x 91 (L) x 14 (D)	650



Temporary Earth Stake - TEN

Part No. Various

- For temporary earthing applications
- Drive rod at a safe working height, minimise risk of back injury
- No pinch points - internal hammer design
- TENW001 - 600mm depth mark on drive rod
- TENW008 - 770mm to attachment point

Features

- Slide hammer drive
- T-Handle lock screw secures sliding shaft for safety, transport and storage
- Non-slip rubber hand grips (TENW001)
- Stainless steel rod (TENW001) Plated steel rod (TENW008)
- Heavy duty top bash cap
- Chiselled tip for easy driving



Earth clamp attachments

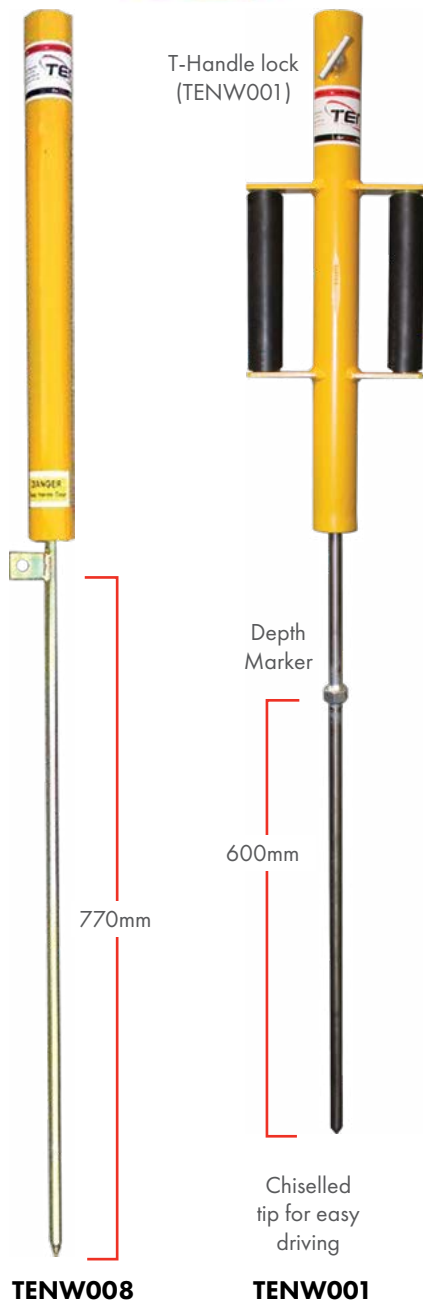

TENW008

TENW001

**Reduce the risk of injury
when installing earth rods**

iTOOLco.

Slide Hammer Drive

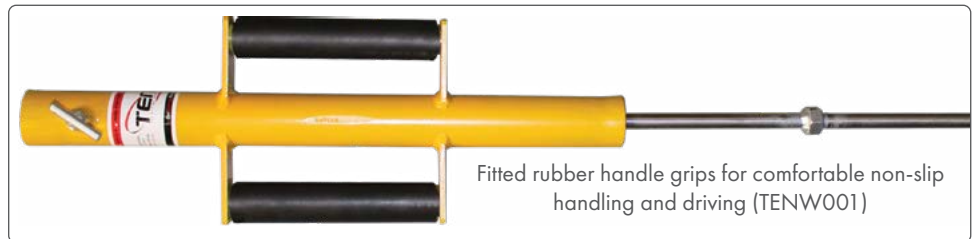

Fitted rubber handle grips for comfortable non-slip handling and driving (TENW001)

Earth Rod Driver - iTOOLco

Part No. GRD01

Safely drive 9.5mm, 12.7mm, 14mm, 16mm and 19mm Earth rods into the ground in under a minute with iTOOLco's Ground Rod Dawg™. Once the rod is driven down far enough the tool can be used to hammer from top to finish the driving.

Features

- Drive earthing rods faster and safer
- Hardened tool steel construction for long life
- Multiple size rods can be driven
- SDS Max driver bit for positive connection and secure driving of rods



Ground Sinker
For driving the top of the
ground rod below grade

Never drive earth rods from a ladder again





DERANCOURT

Derancourt hand tools are manufactured for working near live parts or potentially live parts with ratings up to 1000VAC and 1500VDC.

PUT SAFETY IN YOUR HANDS

Derancourt is a world class manufacturer of quality electrician and power utility worker 1000V Insulated Hand Tools. Stringent manufacturing standards, quality assurance and extensive testing ensures the highest level of quality – translating to better safety outcomes.

Derancourt tools are manufactured in accordance with IEC/EN60900 and undergo rigorous testing to ensure full compliance to these standards. Every Derancourt tool is inspected and are batch identified for easy traceability, so you can be sure your using the safest tool for the job at hand.



Insulated hand tools are classified into three categories:

Insulated Hand Tools: Hand tools made of conductive material(s) fully or partially covered by insulating material.

Insulating Hand Tools: Hand tools made totally or essentially from insulating material(s) except for inserts made from conductive materials used for reinforcement, but with no exposed conductive point.

Hybrid Hand Tools: Hand tools made from insulating material(s) with exposed conductive parts at the working head (e-g cutting edges) (some non-exposed conductive part can be used for reinforcement).

This is an important distinction when risk assessing and implementing controls for electrical hazards in the work area.

Coating

The coatings of DERANCOURT insulated tools consists of two layers:

1. Rigid internal layer, white or red and highly dielectric.
2. Soft orange or red outer layer, protecting the inner layer from impacts and improving comfort during use.

This also acts as a visual inspection. If the white or red can be seen under the top layer, then the tools electrical properties have been compromised and the tool should be removed from service. Smart design such as finger stops on the pliers made from an elastomer material reduces the effect of impacts and preserves the insulating coating

Quality Assurance and Testing

Hybrid, insulating and insulated hand tools must satisfy the tests of the IEC EN 60900 standard.

Derancourt extensively test their products to meet and exceed this standard

- Dimensional control
- Impact tests
- Dielectric test
- Penetration test
- Adherence test
- Flame non-propagation test
- Mechanical tests
- Marking resistance test

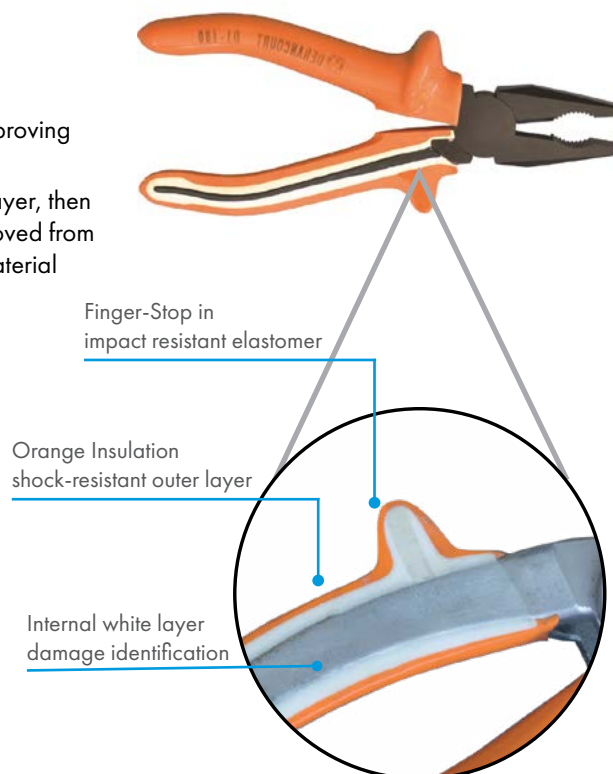
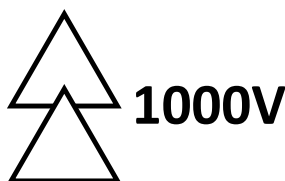

The extensive testing and quality manufacturing processes is the assurance you are safer with Derancourt.



1000V INSULATED HAND TOOLS

Multi-grip and Pliers

Multi-grip Pliers

Part No. Various

- Secteded multi-grip pliers - double grooves
- Burnished finish

Part No.	Length (mm)	Opening (mm)	Wt (kg)
D301-310	310	42	0.7
D5	245	36	0.4

Long Nose Pliers - Fully Insulated

Part No. Various

- Long straight-nose half-round pliers
- Fully insulated pliers to limit any risk of short-circuits
- Straight serrated jaws, half-round
- Induction hardened, diagonal cutting edges

Part No.	Length (mm)	Wt (kg)
D22D-160I*	165	0.2
D22D-200I*	205	0.3

*Fully Insulated

Combination Pliers

Part No. Various

- Combination pliers fully insulated to jaws
- Fully insulated pliers to limit any risk of short-circuits
- Flat end grip with cutter jaw
- Rectangular gripping area, straight serration with tube grip
- Induction hardened, diagonal cutting edges

Part No.	Length (mm)	Wt (kg)
D1-180	185	0.3
D1-180I*	185	0.3
D1-200I*	205	0.4

*Fully Insulated

Cutters

Diagonal Cutters

Part No. D3-Series

- Electrician's diagonal cutting pliers
- Diagonal cutters for mild steel wire, cutting edge with axial cut
- Insulated & Fully Insulated

Part No.	Length (mm)	Wt (kg)
D3-180	185	0.4
D3-180I*	185	0.4

*Fully Insulated

Cable Cutters

Part No. D180-210

- Precision Cable Cutter

Part No.	Length (mm)	Wt (kg)
D180-210	210	0.4

Part No. D18-220

- High Strength Cable Cutter
- Max 20mm CU/AL

Part No.	Length (mm)	Wt (kg)
D18-220	220	0.4





Ratchet Cutters

ACSR, AL and CU

Part No. K Series



Part No.	Jaw	Length (mm)	Cuts		Wt (kg)
			ACSR (mm)	AL/CU (mm)	
KT471	Closed	265	-	45	0.8
KT501	Closed	230	17 (11mm Steel)	22	1.3
KTF361	Open	320	-	36	1.3

Parrot Beak Cutters - Large

AL, CU and Steel

Part No. C Series



Part No.	Length (mm)	Cuts OD (mm)	Wt (kg)
C16	660	Cu/Al 20, Soft St 16, Hard St 10	2.8
C600	600	Cu/Al 35	2.1

Bolt Cutters

Part No. D60 Series

- Efficient and easy to handle



Part No.	Length (mm)	Steel Cutting Capacity (mm)	Wt (kg)
D60N0	480	8 Dia. (60kg/ mm ²) - 6 Dia. (140 kg/ mm ²)	1.9
D60N1	645	10 Dia. (60kg/ mm ²) - 8 Dia. (140 kg/ mm ²)	2.9
D60N2	770	13 Dia. (60kg/ mm ²) - 9 Dia. (140 kg/ mm ²)	4.6
D60N3	940	14 Dia. (60kg/ mm ²) - 10 Dia. (140 kg/ mm ²)	6.7

1000V Insulated Battery Powered Cutters



20mm Cutter

Cuts
Cu, Al
& ACSR



25mm Cutter

Klauke
NEXT
GENERATION



32mm Cutter

Cuts
Cu & Al



50mm Cutter

Refer Hydraulic Section for more information on 1000V Insulated Battery Cutters

DERANCOURT

Knives & Hacksaw

Knives

- 1000V insulated - conforms to CEI 900 and NF EN 60900
- Treated steel blade
- Excellent cutting quality - stays sharp
- Guiding "V" for longitudinal cut
- Insulation with injected rigid insulating material
- Bi-material handle (for ease of use and good grip)

Part No. CL-IS

Insulated Knife with Curved blade

Part No.	Length (mm)	Blade Length (mm)	Wt (kg)
CL-IS	168	42	0.65
CL-IS-E	As Above, including Sheath		0.85

Part No. D1001-IS

Insulated Knife with Curved blade

Part No.	Length (mm)	Blade Length (mm)	Wt (kg)
D1001-IS	190	64	0.75
D1001-IS-E	As Above, including Sheath		0.85

Part No. C1-IS

- Insulated Knife with straight blade

Part No.	Length (mm)	Blade Length (mm)	Wt (kg)
C1-IS	182	56	0.75
C1-IS-E	As Above, including Sheath		0.85

Hacksaw

Part No. D72-IS

- Light frame made of reinforced insulating material.
- Ergonomic bi-material handle for optimal grip.
- Quick release device for the blade with retractable tensioner.
- Hand stop at the front of the mount.

Part No.	Length (mm)	Blade Length (mm)	Wt (kg)
D72-IS	440 (L) x 160 (H)	300	0.5

For 1000V Stripping Tools
Refer page G17





Screwdrivers

Flat Blade

Part No. Various

- 1000V insulated - conforms to CEI 900, NF EN 60900
- ISO 2380:D23/TB, ISO 8764:CRU
- Vanadium chrome steel

Part No.	Shaft Length (mm)	Width (mm)	Wt (kg)
TB-2.5X50B	50	2.5	0.20
TB-3.5X100	100	3.5	0.45
TB-4X100B	100	4.0	0.50
TB-5.5X150	150	5.5	0.90
TB-6.5X150	150	6.5	0.12
TB-8X150	150	8.0	0.16
TB-10X150	150	10	0.22
TB-12X200	200	12	0.35

Phillips Head

Part No. Various

Part No.	Shaft Length (mm)	Width (mm)	Wt (kg)
CRU-3X100	100	3	0.45
CRU-4X75	75	4	0.50
CRU-5X100	100	5	0.75
CRU-6X100	100	6	0.95
CRU-6X125	125	6	0.11
CRU-8X150	150	8	0.16
CRU-10X200	200	10	0.27

**Ergonomic, Soft Touch
Screwdrivers Available**



Shifters and Spanners

Shifters (Standard Insulated & Fully Insulated)

Part No. D19 Series

- 1000V insulated - conforms to CEI 900, NF EN 60900 & ISO 6787
- Invisible slip joint
- Chrome vanadium steel, easy jaw roller

Part No.	Type	Length (mm)	Opening (mm)	Wt (kg)
D19-110	Insulated	120	13	0.1
D19-150	Insulated	160	20	0.2
D19-200	Insulated	210	24	0.3
D19-250	Insulated	260	28	0.5
D19-300	Insulated	310	34	0.8
D19-375	Insulated	385	43	1.5
D19-200I*	Fully Insulated	215	27	0.5
D19-250I*	Fully Insulated	265	32	0.6
D19-300I*	Fully Insulated	315	36	1.0

* Fully Insulated





Offset Ring

Part No. D13 Series

- Single head. Made from forged steel, vanadium chrome steel.
- Easier to remove embedded nuts angled 12 point fine heads.
- Chamfer makes it easier to position

Part No.	Length (mm)	Size (mm)	Wt (kg)
D13-10	175	10	0.90
D13-11	175	11	0.95
D13-12	190	12	0.12
D13-13	190	13	0.13
D13-14	200	14	0.15
D13-15	200	15	0.15
D13-16	215	16	0.18
D13-17	215	17	0.19
D13-18	230	18	0.23
D13-19	230	19	0.23

Straight Ring

Part No. D12 Series

- Single Head 12 points

Part No.	Length (mm)	Size (mm)	Wt (kg)
D12-10	120	10	0.35
D12-11	120	11	0.40
D12-12	130	12	0.50
D12-13	130	13	0.60
D12-14	130	14	0.65
D12-15	130	15	0.70
D12-16	150	16	0.90
D12-17	150	17	0.11
D12-18	165	18	0.12
D12-19	170	19	0.14
D12-21	180	21	0.17

Straight Ratchet Ring Spanners (D70-Series) also available - Contact TEN for further information

Single Open Ended

Part No. D14 Series

- Single open-end wrench

Part No.	Length (mm)	Size (mm)	Wt (kg)
D14-10	110	10	0.35
D14-11	110	11	0.34
D14-12	125	12	0.50
D14-13	135	13	0.55
D14-14	145	14	0.70
D14-15	145	15	0.75
D14-16	155	16	0.10
D14-17	155	17	0.10
D14-18	160	18	0.14
D14-19	165	19	0.14
D14-21	180	21	0.20



Wrenches

Reversible Ratchet Wrenches - 1/2" & 3/8" Drive

Part No. C Series

- Equipped with a mechanical locking device to hold the socket in place
- Highly resistant insulating materials.
- Bi-material non-slip handle with "soft" touch for a good grip.
- Large button for reversing the direction of rotation.

Part No.	Length (mm)	Drive	Wt (kg)
C200IVM	213	3/8"	0.43
C250IVM	262	1/2"	0.63

Torque Wrenches - 1/2" Drive - 8-60Nm

Part No. CD8 Series

- For precision tightening
- Automatic release and reset
- Graduated adjustment
- 8-60Nm - Accuracy 4%
- Torque adjuster locked during use
- Supplied with serial number and verification certificate

Part No.	Length (mm)	Drive	Wt (kg)
CD8-60-12	310	1/2"	1.0
CD8-60R-12	310	1/2"	1.0

Torque Wrenches - 3/8" Drive - 4-20Nm

Part No. CD4-20

- Insulated torque wrench. 4-20 Nm.
- Graduated adjustment
- Torque adjuster locked during use
- Supplied with serial number and verification certificate

Part No.	Length (mm)	Drive	Wt (kg)
CD4-20	230	3/8"	0.9

Torque Wrenches - 3/8" Drive - 8-60Nm

Part No. CD8-60-3.8

- Insulated torque wrench. 8-60 Nm.
- Graduated adjustment
- Torque adjuster locked during use
- Supplied with serial number and verification certificate

Part No.	Length (mm)	Drive	Wt (kg)
CD8-60R-3.8	310	3/8"	1.0

T-Handle Wrench - 1/2" Drive

Part No. T250

- Accepts 1/2" Drive Sockets
- 3/8" also available

Part No.	Length (mm)	"T" Handle (mm)	Wt (kg)
T250	300	205 (L)	0.6



CD8-60-12

CD8-60R-12
(Reversible)



R250-250

Socket Extensions

125mm & 250mm Long

Part No. C250 Series

- Vanadium chrome steel
- 1/2" square drive

Part No.	Length (mm)	Wt (kg)
R250-125	125	0.2
R250-250	250	0.4



R250-125

Sockets 3/8" and 1/2" Drive

Part No. Various

12 Point Socket - 1/2" Drive

Part No.	Size (mm)	Length (mm)	Wt (kg)
D250-12P-8	8	55	0.60
D250-12P-10	10	55	0.60
D250-12P-11	11	55	0.60
D250-12P-13	13	55	0.65
D250-12P-16	16	55	0.75
D250-12P-17	17	55	0.80
D250-12P-18	18	60	0.90
D250-12P-19	19	60	0.90



D250 - 12 point

6 Point Socket - 1/2" Drive

Part No.	Size (mm)	Length (mm)	Wt (kg)
D250-6P-13	13	55	0.65
D250-6P-16	16	55	0.75
D250-6P-17	17	55	0.80
D250-6P-18	18	59	0.85
D250-6P-19	19	60	0.90



D250 - 6 point

12 Point Long Socket - 1/2" Drive

Part No.	Size (mm)	Length (mm)	Wt (kg)
DL250-12P-13	13	91	0.15
DL250-12P-16	16	91	0.17
DL250-12P-17	17	91	0.17
DL250-12P-18	18	91	0.18
DL250-12P-19	19	91	0.19



DL250 - 12 point

Other sizes available. Contact TEN for further information

3/8" Drive 6 and 12 Point Sockets



Also available



D200-6P/12P	DL200-6P/12P
3/8" insulated 6 & 12-point socket, From 7 to 24mm	3/8" insulated 6 & 12-point long socket From 7 to 24mm (91mm Long)

Also available in 1/2" Square Drive - Contact TEN for further information



M200 & M250

Hex Head Socket - M200 (3/8") & M250 (1/2")

Part No.	Size (mm)	Length (mm)	Wt (kg)
3/8" Drive			
M200-4	4	OAL 60	0.11
M200-5	4	OAL 60	0.12
1/2" Drive			
M250-4	4	15 Hex Length	0.075
M250-5	5		0.075
M250-6	6		0.080
M250-7	7		0.085
M250-8	8		0.085
M250-9	9		0.090
M250-10	10		0.095

Offset Socket - 17 & 19mm

Part No. D11 Series

- Single head, hexagonal 12 points
- Made from forged vanadium chrome steel.
- Deep, resistant socket,
- Strong handle to allow for powerful tightening

Part No.	Length (mm)	Size (mm)	Wt (kg)
D11-17	185	17	0.29
D11-19	195	19	0.43

Fixed Socket - T handle Wrench

Part No. D55 Series

- Entire tube in the shape of a hexagon socket screw key.
- Heat treated steel.

Part No.	Length (mm)	Size (mm)	Wt (kg)
D55-13-300	300	13	0.43
D55-18-300	300	18	0.70
D55-19-300	300	19	0.75
D55-19-400	400	19	0.90
D55-20-400	400	20	0.13

Radio and T-Handle Sockets



Also available



D21 - Radio Wrench	D15 - T-Handle Socket
Radio Wrench Heat treated steel Entire tube in the shape of a hexagon socket screw key.	T-Handled socket wrench (short). Heat treated steel Entire tube in the shape of a hexagonal socket screw wrench.

Other sizes and styles available. Contact TEN for further information



Allen Keys

T-Handle

Part No. T62 Series



Part No.	Size (mm)	Length (mm)	Wt (kg)
T62-120-5	5	120	0.10
T62-175-3	3	175	0.17
T62-175-4	4	175	0.17
T62-175-5	5	175	0.05
T62-180-6	6	180	0.20
T62-95-4	4	95	0.10

Curved (+Set) Short Connector & Screwdriver Handle



D62 - Curved Allen Key	D62DJEUI - Curved Allen Key set	D62C - Short Hex	CMD - Straight Allen Key
Curved Allen key. Vanadium chrome steel OAL 120mm, handle 80mm	Kit of 8 Allen Keys on ring Sizes 1.5, 2, 2.5, 3, 4, 5, 6 & 8	Short hex connector. Vanadium chrome steel	Vanadium chrome steel Screwdriver style handle

Contact TEN for available styles and sizes

Fuse Extraction Tool

Part No. DA30IS

- For safe removal of Metal clad service fuses (handbag connections)
- High Mechanical Strength
- Size adjustable Jaws



Part No.	Length (mm)	Jaw Opening (mm)	Wt (kg)
DA30IS	300	20 to 94	0.18

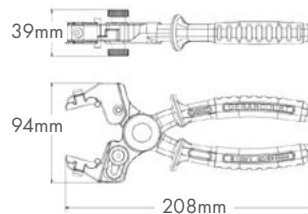

Socket Sets, Tool Kits & storage solutions available. Contact TEN for more information.



TEN's Storage Solutions

TEN Manufactured Canvas and PVC Products

TEN's range of quality Australian made storage solutions and accessories are industry proven and tested to our stringent quality standards.

A range of options are available including customised logos, identification numbers & warning labels. All our manufactured products use the highest quality materials.

PVC

Australian made 680gsm high tenacity PVC made in a tear stop construction commonly used in extra heavy duty tarpaulins. Tear stop design decreases the chances of a tear or cut in the material from increasing. The base fabric is lacquer coated for extra protection and dirt resistant. It is also flame retardant, mildew resistant and UV resistant.

Heavy Duty Canvas

Our Tear stop canvas has core spun threads woven throughout for added strength and resistant to damage. The fabric is 535gsm, UV and mildew resistant, features excellent shrink and colour control and is completely breathable minimising internal moisture build up. This canvas is made tough for the harsh Australian conditions and is commonly used in the transport industry.

Webbing & Stitching

Our heavy duty polyester webbing (also known as seat belt webbing) is used for its strength and low elongation under load. It is ideal for support banding and handles, it is light and strong minimising excess weight for the operator. All our stitching patterns and materials are designed to provide maximum strength and resistance to tears improving the durability and longevity of your storage solutions.

Ultrasonic Welded Seams

TEN provides ultrasonic welded seams on selected PVC material bags featuring a welded seam icon. Equipment bags face the toughest Australian and New Zealand conditions exposed to the sun, rain, heat and cold. Sewn seam bags can take on water if water pools on top of seams. By utilising radio frequency energy to instantly heat the thermoplastic coating this enables the two sheets of PVC to be permanently fused together giving a water tight join.

Whilst physically not as strong as a sewn seam it does have its own distinct advantages including abrasion resistance at the seam, resistant to thread decay and a neat flush finish.

What makes a TEN bucket bag the toughest?



Quality Australian Made Canvas and PVC Products for the Utility, Rail and Mining Sectors

Ultrasonic Welding

Ultrasonic welding is an industrial process whereby high-frequency ultrasonic acoustic vibrations are locally applied to workpieces being held together under pressure creating a solid-state weld.

Why Ultrasonic welding?

Ultrasonic welding is by far the best method for joining PVC materials. The weld is much stronger, compared to other technologies, such as hot air, hot wedge or impulse welding. The resulting weld is also airtight and waterproof.

Advantages!

- Repeatable, reliable technology
- Strong, durable and even welds
- Waterproof
- Multi-layer welding
- An environmentally friendly choice



Welded Seam Icon



Call TEN to discuss how we can assist with your TOOL & EQUIPMENT needs